

Construction Features:

- Bolted or Welded Bonnet
- OS&Y
- Threaded Ends or SW Ends
- Rising Stem
- Integral HF Seat

Standards:

- End Threads: ANSI B1.20.1
- Socket-Weld: ANSI B16.11
- Basic Design: API 602
- Test: API 598

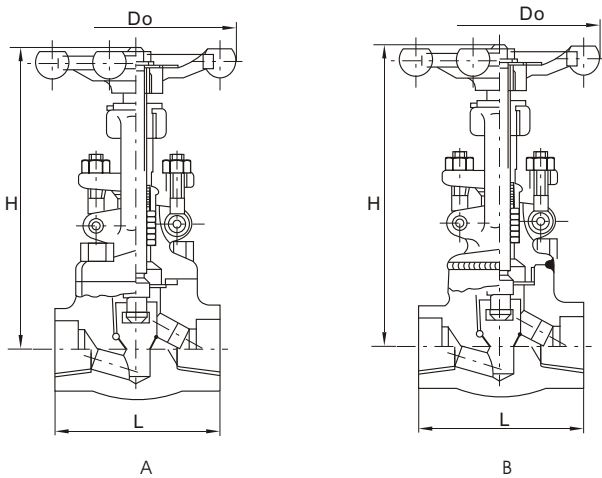

CLASS 150-800

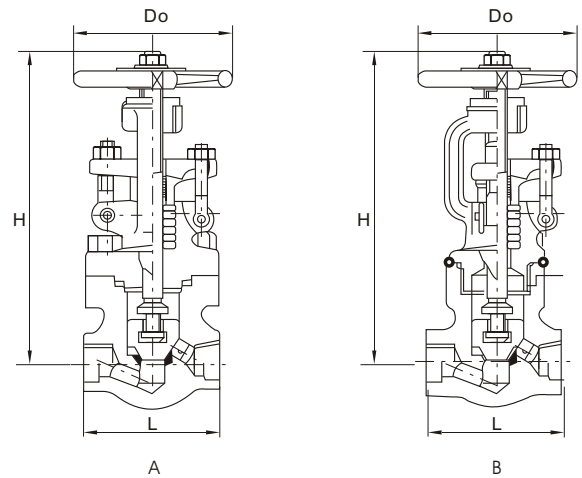

CLASS 1500

MATERIAL LIST

Part Name	Material	Qty
Body	A105	1
Seat	Stellite Overlay	1
Disc	A276-420	1
Stem	A276-410	1
Gasket(Spiral Wound)	SS304/Graphite	1
Bonnet	A105	1
Bolt	A193-B7	4
Eyebolt Pin	A276-410	2
Packing	Graphoil	
Gland	A276-410	1
Gland Flange	A105	1
Eyebolt Nut	A194-2H	2
Eyebolt	A276-410	2
Stem Nut	A276-410	1
Washer	150-800 A276-430 1500 A108-1020	1
Lock Nut	A108-1020	1
Handwheel	A47	1

DIMENSIONS & WEIGHTS

Class	Nominal Size	Regular Port	mm(in)	15(1/2)	20(3/4)	25(1)	32(1-1/4)	40(1-1/2)	50(2)	
		Full Port	mm(in)	10(3/8)	15(1/2)	25(3/4)	25(1)	32(1-1/4)	40(1-1/2)	50(2)
150 800	d		mm	10	13	17.5	23	30	35	46
	L		mm	79	92	111	120	152	172	200
	H	A	mm	167	167	204	228	252	295	327
		B	mm	176	176	218	236	254	295	327
	D ₀		mm	100	100	125	160	160	180	240
	Weingt	A	kg	2.2	2.3	4.2	6.2	7.8	12.3	17
B		kg	1.9	2.1	3.9	5.8	7.2	10.8	16	

DIMENSIONS & WEIGHTS

Class	Nominal Size	Regular Port	mm(in)	15(1/2)	20(3/4)	25(1)	32(1-1/4)	40(1-1/2)	50(2)
		Full Port	mm(in)	10(3/8)	15(1/2)	20(3/4)	25(1)	32(1-1/4)	40(1-1/2)
1500	d		mm	10	13	17	23	30	38
	L		mm	111	111	130	152	172	220
	H	A	mm	207	207	240	258	290	337
		B	mm	210	210	230	234	290	327
	D ₀		mm	100	100	125	160	160	180
	Weingt	A	kg	4.7	4.6	6.8	9.2	13.6	20.9
B		kg	4.1	4.1	6.2	8.6	12.7	19.1	

Other body and bonnet materials F5 F11 F304 F304L
F316 F316L and LF2 also available upon request