

Construction Features:

- Bolted Cover
- Threaded Ends or SW Ends
- Swing Type Disc
- Rolled-in Seat Ring

Standards:

- End Threads: ANSI B1.20.1
- Socket-Weld: ANSI B16.11
- Basic Design: API 602
- Test: API 598

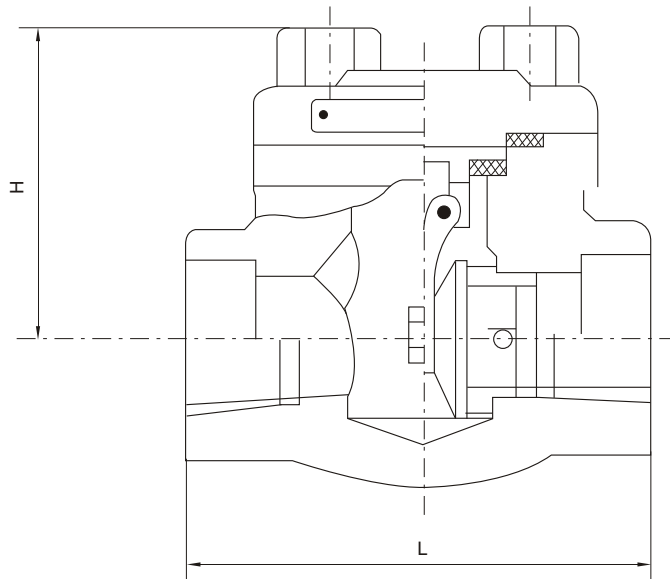

MATERIAL LIST

Part Name	Material	Qty
Body	A105	1
Seat Ring	A276-410+HF	1
Disc	A276-410	1
Gasket(Spiral Wound)	SS304/Graphite	1
Cover	A105	1
Bolt	A193-B7	1
Hinge	A217-CA15	4
Hinge Pin	A217-410	1
Supporter	304SS	1

DIMENSIONS & WEIGHTS

Class	Nominal Size	Regular Port	mm(in)	15(1/2)	20(3/4)	25(1)	32(1-1/4)	40(1-1/2)	50(2)	
		Full Port	mm(in)	10(3/8)	15(1/2)	20(3/4)	25(1)	32(1-1/4)	40(1-1/2)	50(2)
150 800	d	mm	10	13.6	18	24	29	36.5	46	
	L	mm	79	92	111	120	120	140	170	
	H	mm	61	61	78	84	101	120	133	
	Weingt	kg	1.0	1.1	1.9	3.4	4.5	7.3	9.8	

Other body and bonnet materials F5 F11 F304 F304L
F316 F316L and LF2 also available upon request